

# Westlake ES | Bond Committee Meeting

SANTA CRUZ CITY SCHOOLS | 03 DECEMBER 2018

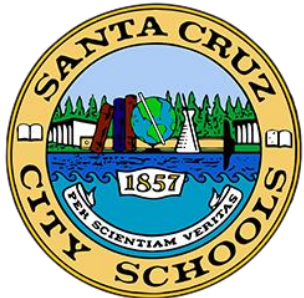

**BARTOS**  
ARCHITECTURE

COLLABORATION  
ADVOCACY  
RESEARCH  
EDUCATION

## Master Plan Diagram: May 22, 2018

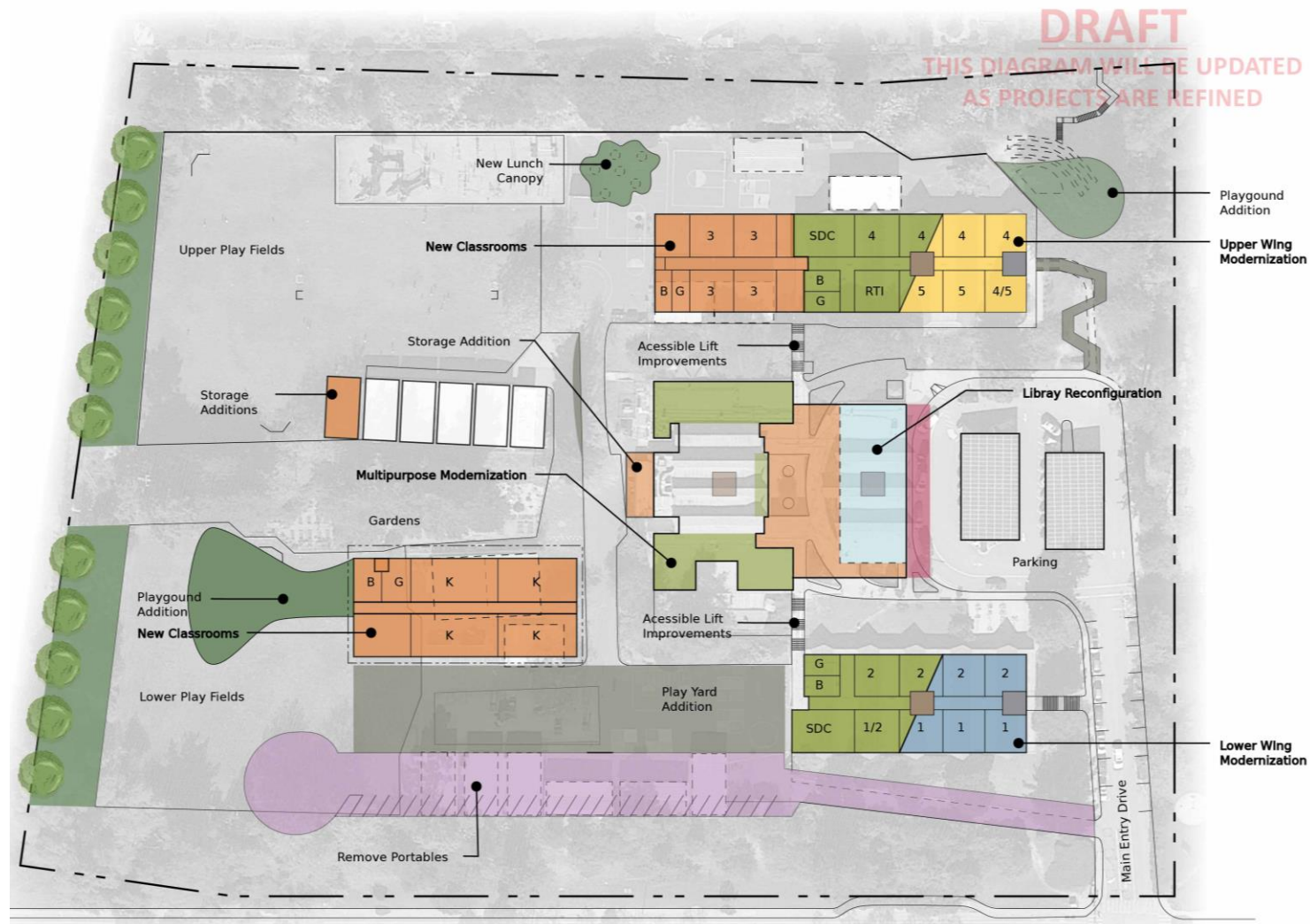

## Floor Plan – Single Story Option



# Measure A | B Update: Westlake Elementary School

## Two Story Building Location Options

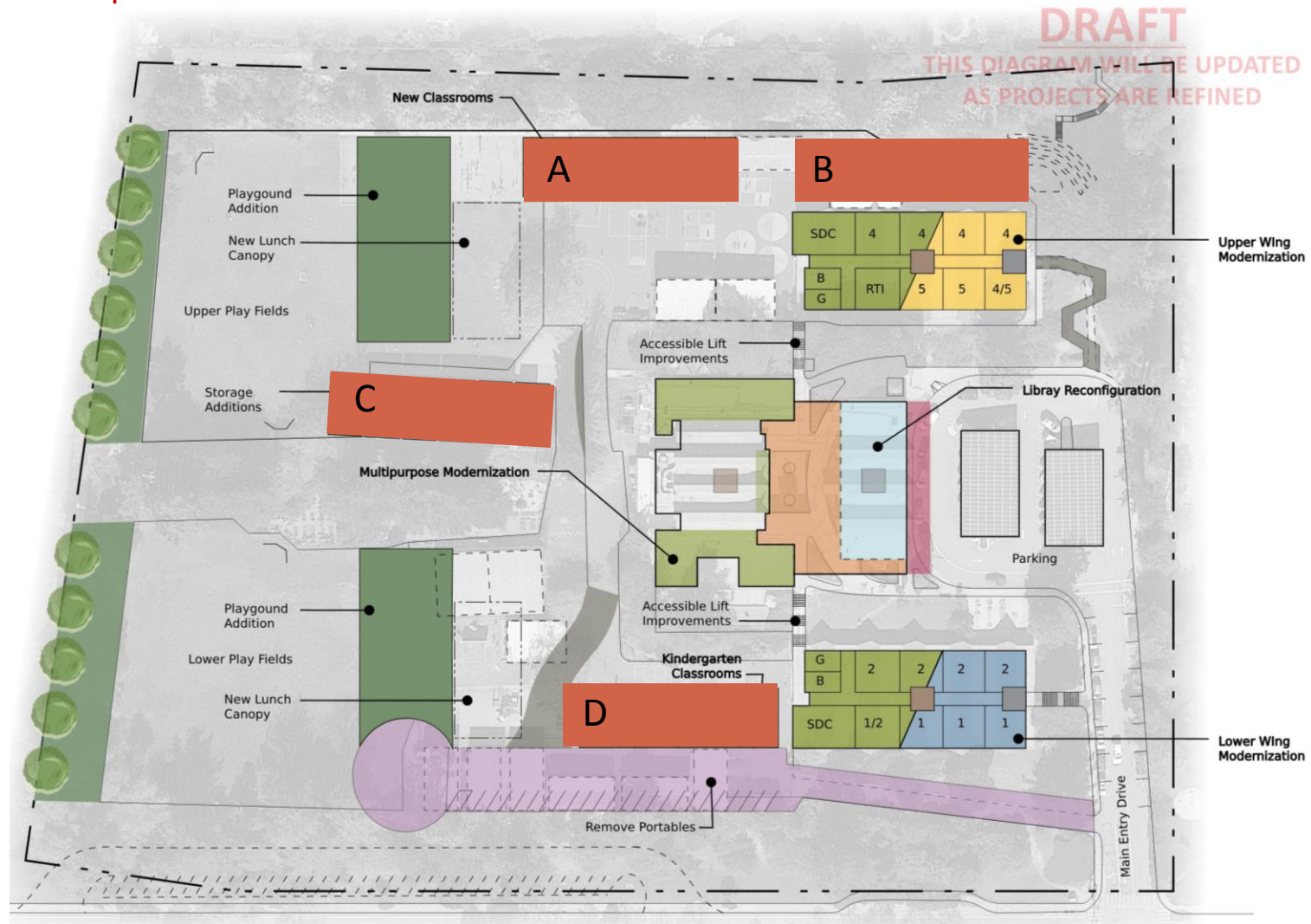



# Measure A | B Update: Westlake Elementary School

## Upper Play Area

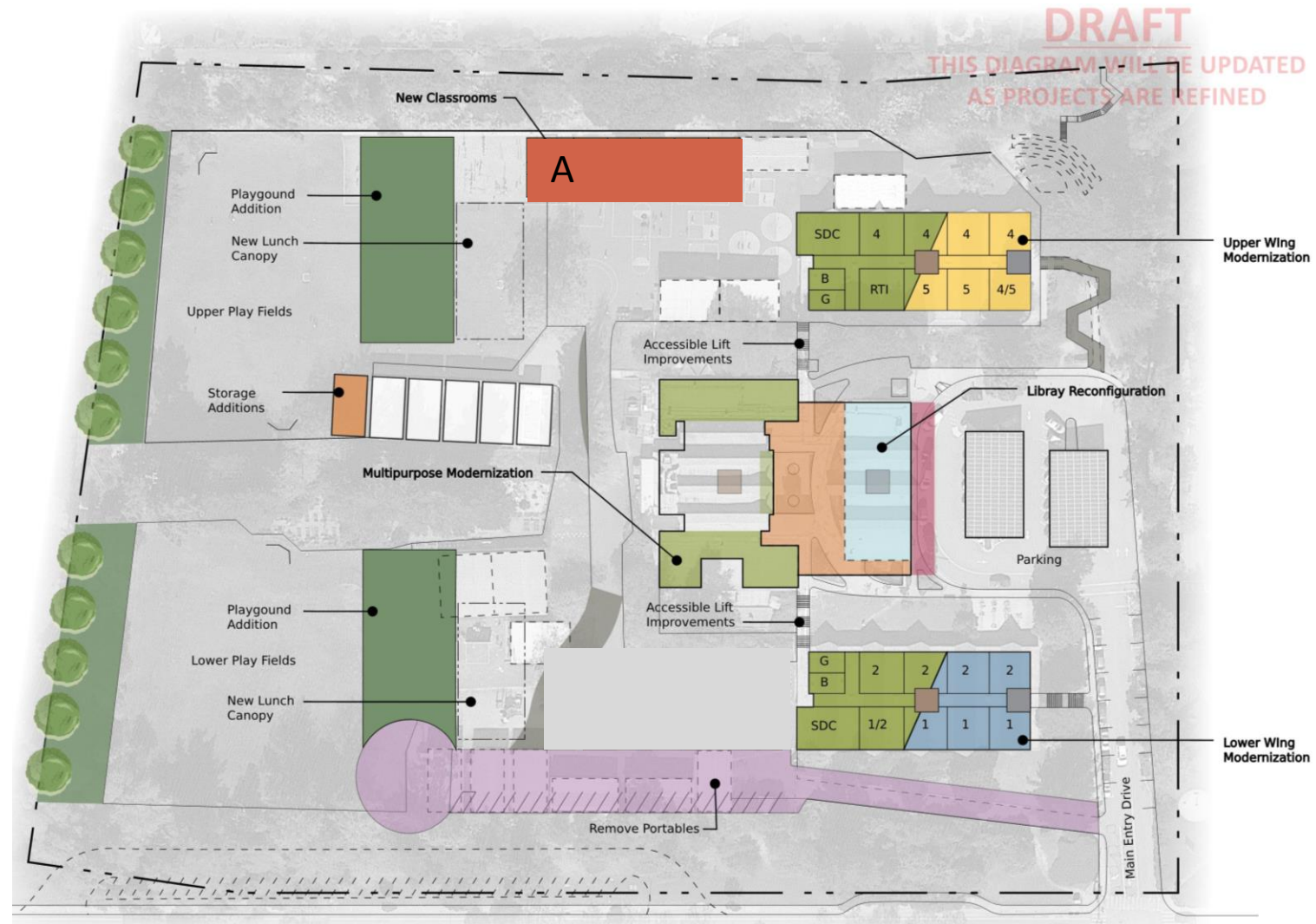

# Measure A | B Update: Westlake Elementary School

Behind Upper Wing

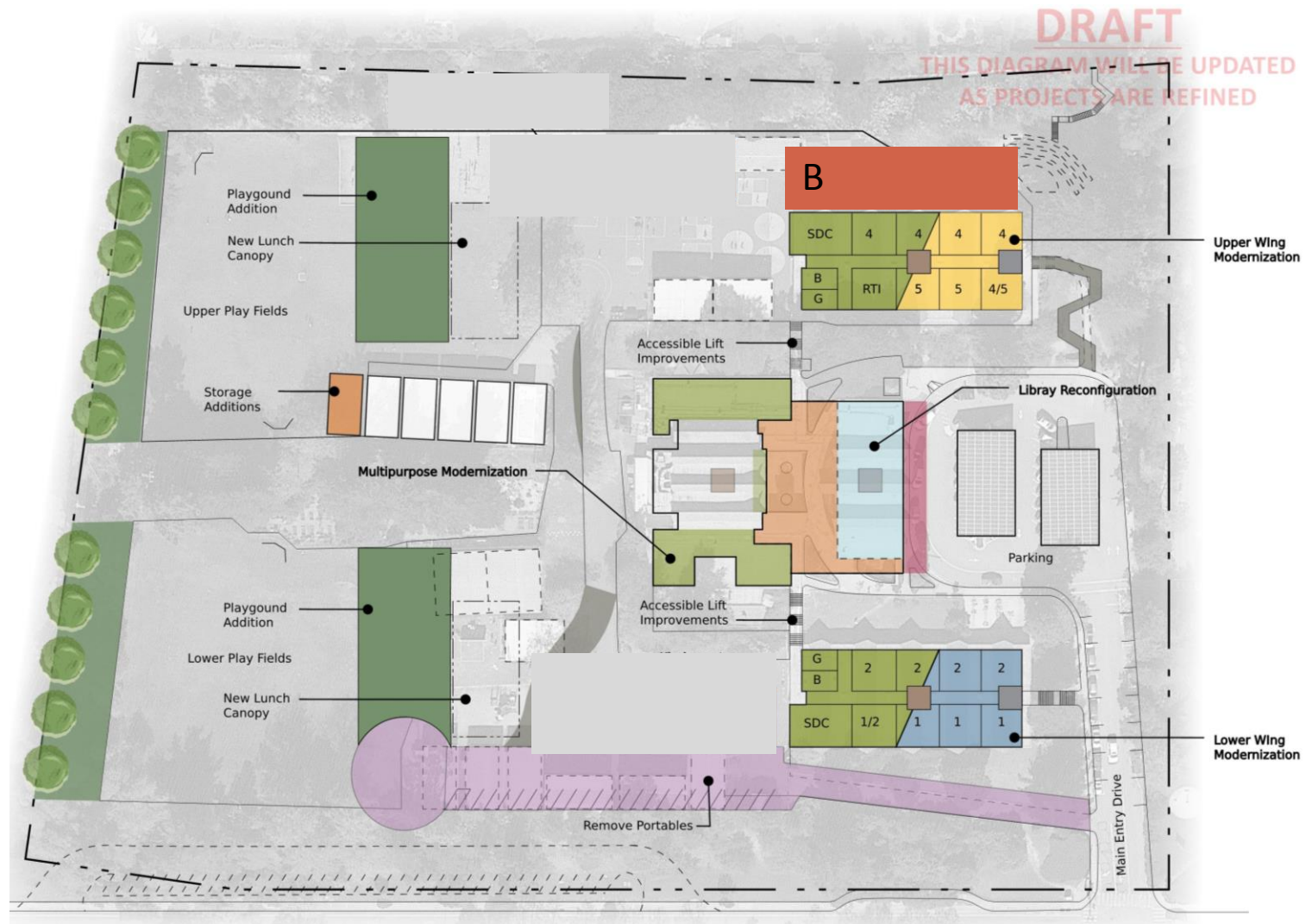

# Measure A | B Update: Westlake Elementary School

At Existing Play area portables

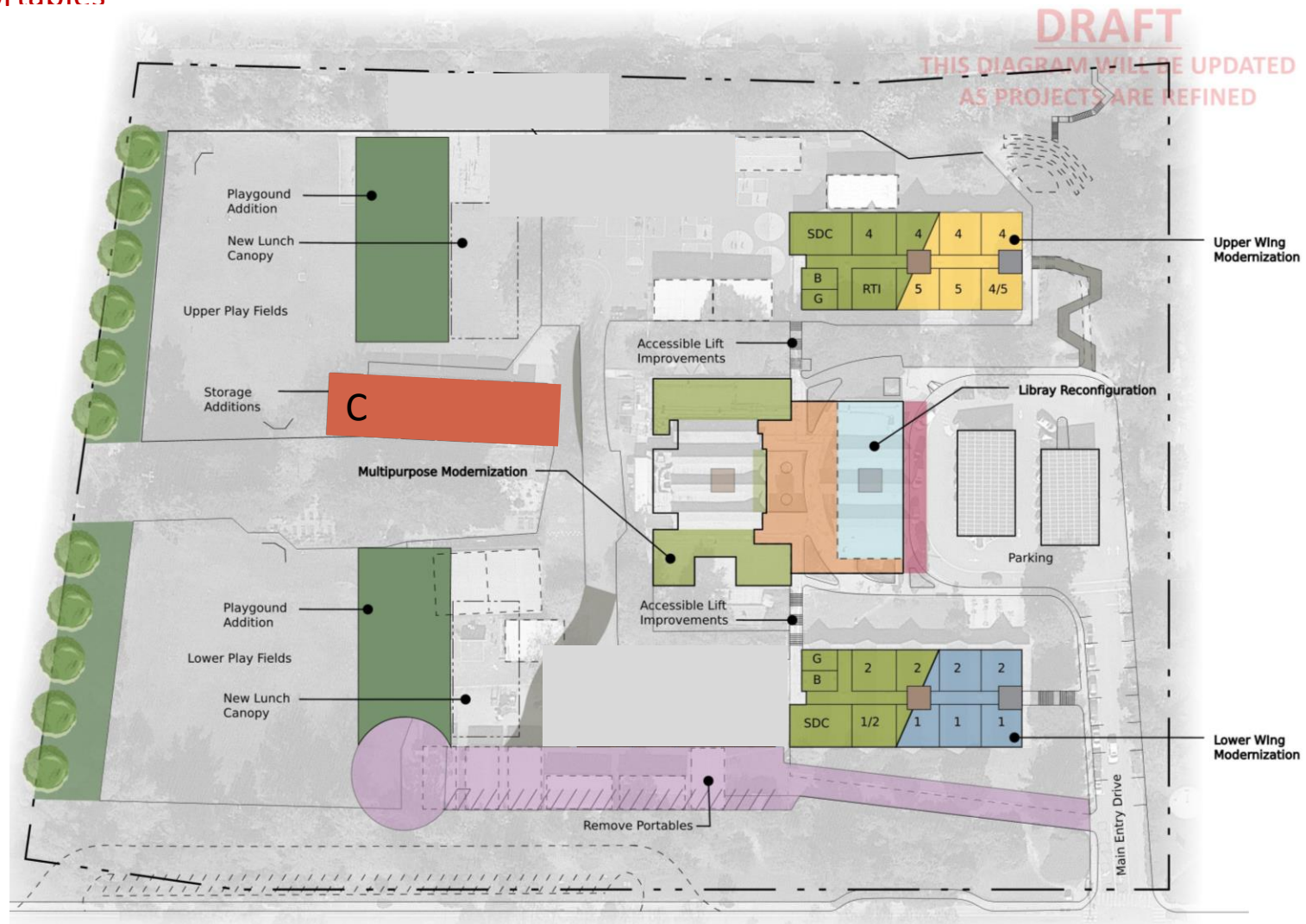



# Measure A | B Update: Westlake Elementary School

At existing Lower Portables





# Measure A | B Update: Westlake Elementary School

## Single Story Option A



# Measure A | B Update: Westlake Elementary School

## Single Story Option B



# Measure A | B Update: Westlake Elementary School

Project	Allocation	Completion
Multi Project Overhead	\$696,000	
Card Access Security System	\$120,000	Summer 2019
Data Infrastructure	\$335,000	Summer 2019
Lower Parking	\$750,000	Summer 2019
Upper Classrooms	\$4,340,952	Winter 2020
Lower Classrooms	\$3,386,505	Winter 2020
Lunch/Play/Misc Site	\$500,000	Summer 2021
Modernization	\$3,400,000	Fall 2021
<i>Budget allocation-ROM only.</i>	\$13,528,457	



# Measure A | B Update

**END**

# Measure A | B Update: Westlake Elementary School



# Measure A | B Update: Westlake Elementary School

## Revised Master Plan Diagram – Option 2 – Two Story Classroom Building





# Measure A | B Update: Westlake Elementary School

## Revised Master Plan Diagram – Option 3 - Two Story Classroom Building

